

AVANT

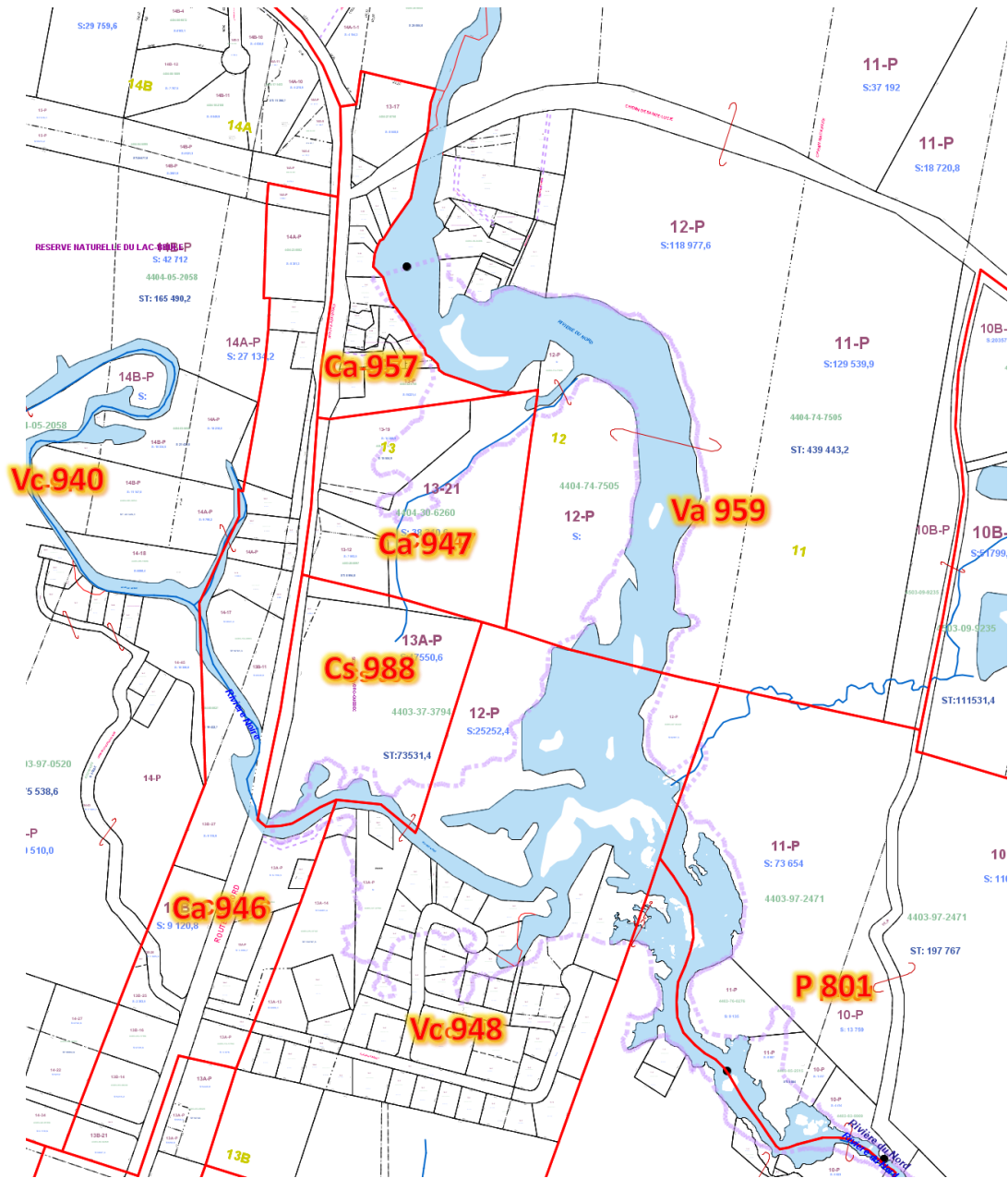

APRÈS

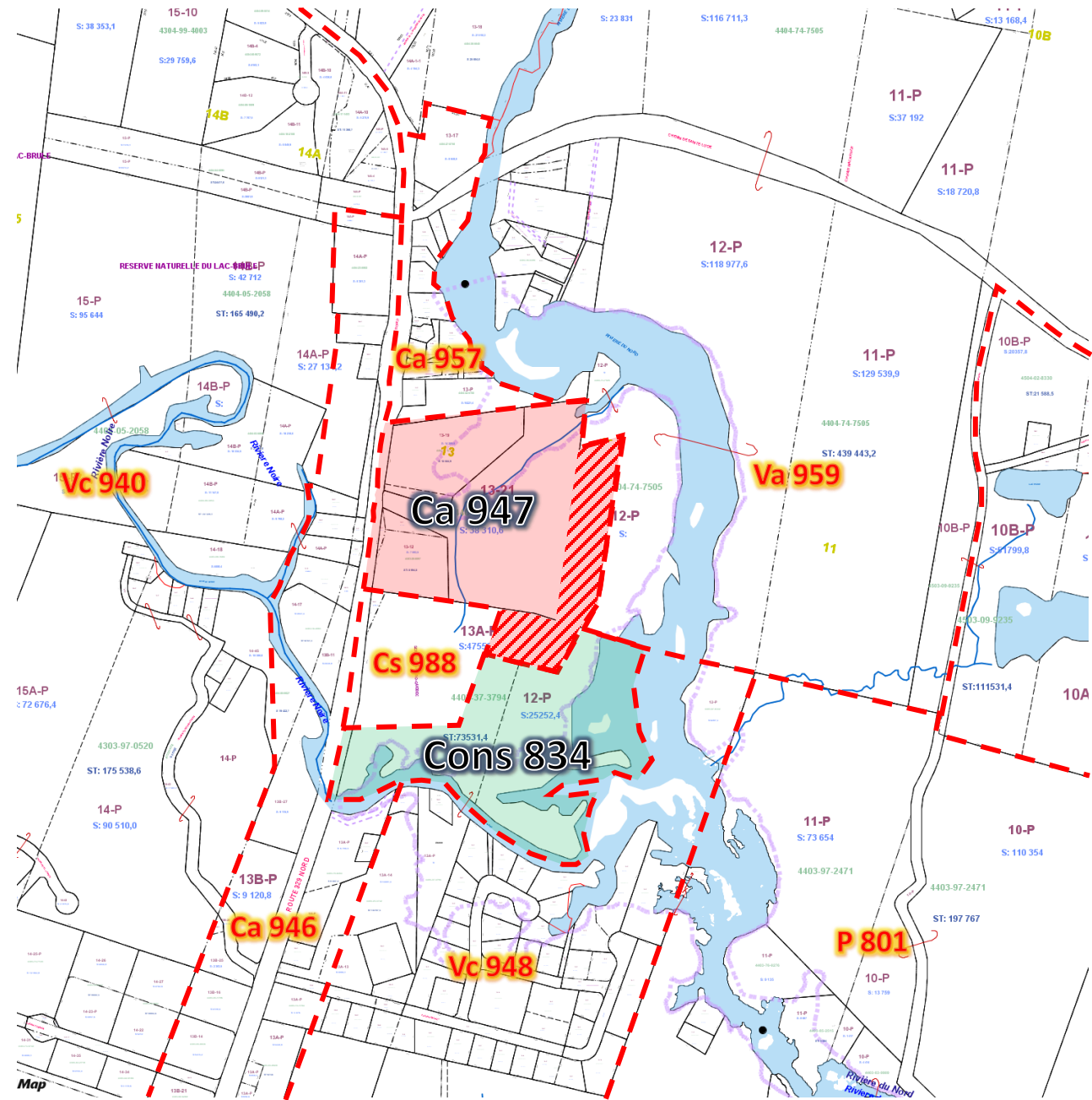

1.2 2020-U53-82 modifiant le règlement de zonage 2009-U53 afin de modifier le plan de zonage ainsi que certaines grilles

- Zones contiguës
- Zone Concernée

| Zone concernée | Zones contiguës |
|----------------|-----------------|
| Ca 947 | Ca 946 |
| | Vc 948 |
| | Ca 957 |
| | Va 959 |
| | Cs 988 |

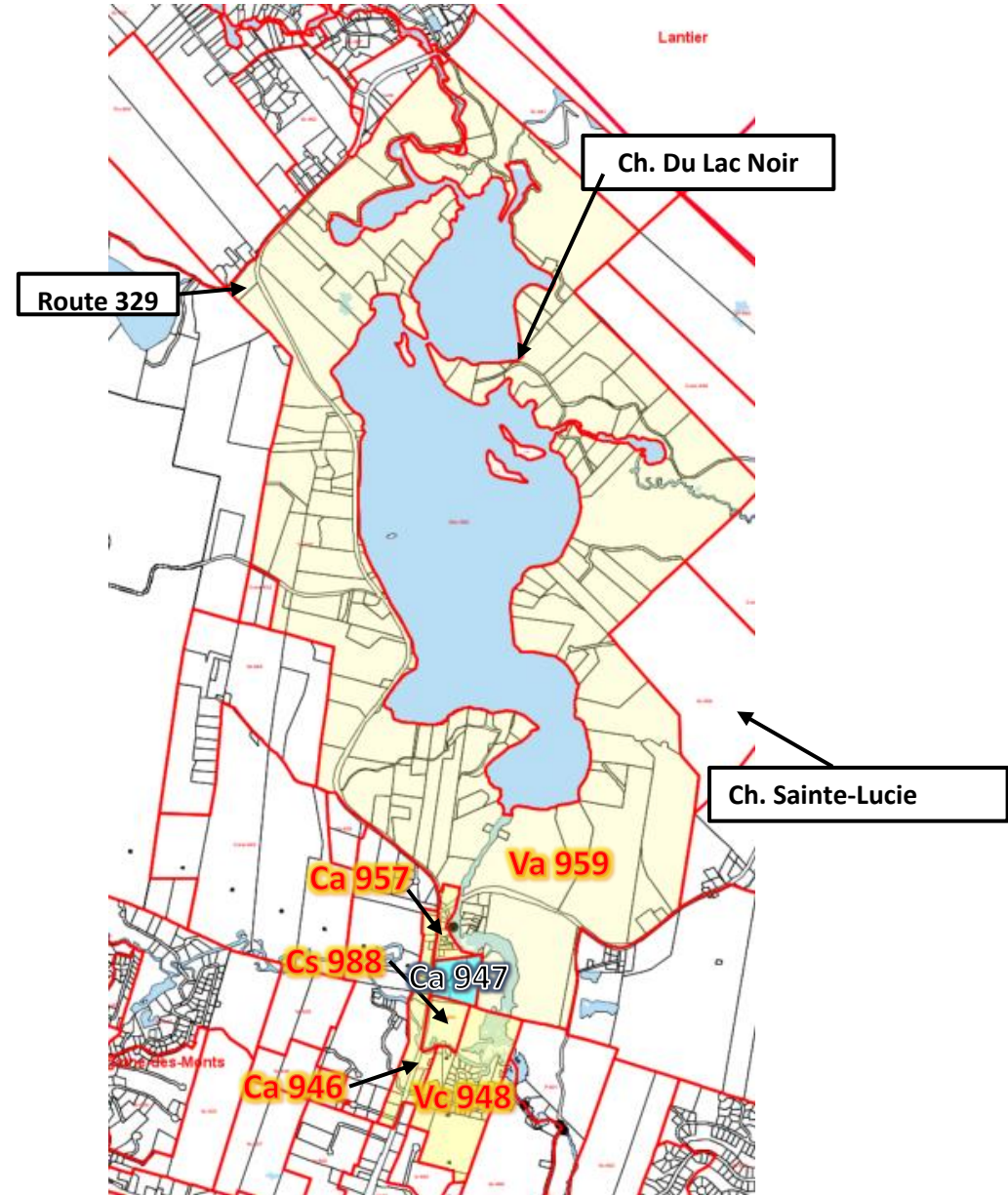



1.2 2020-U53-82 modifiant le règlement de zonage 2009-U53 afin de modifier le plan de zonage ainsi que certaines grilles

- Zones contiguës
- Zone Concernée

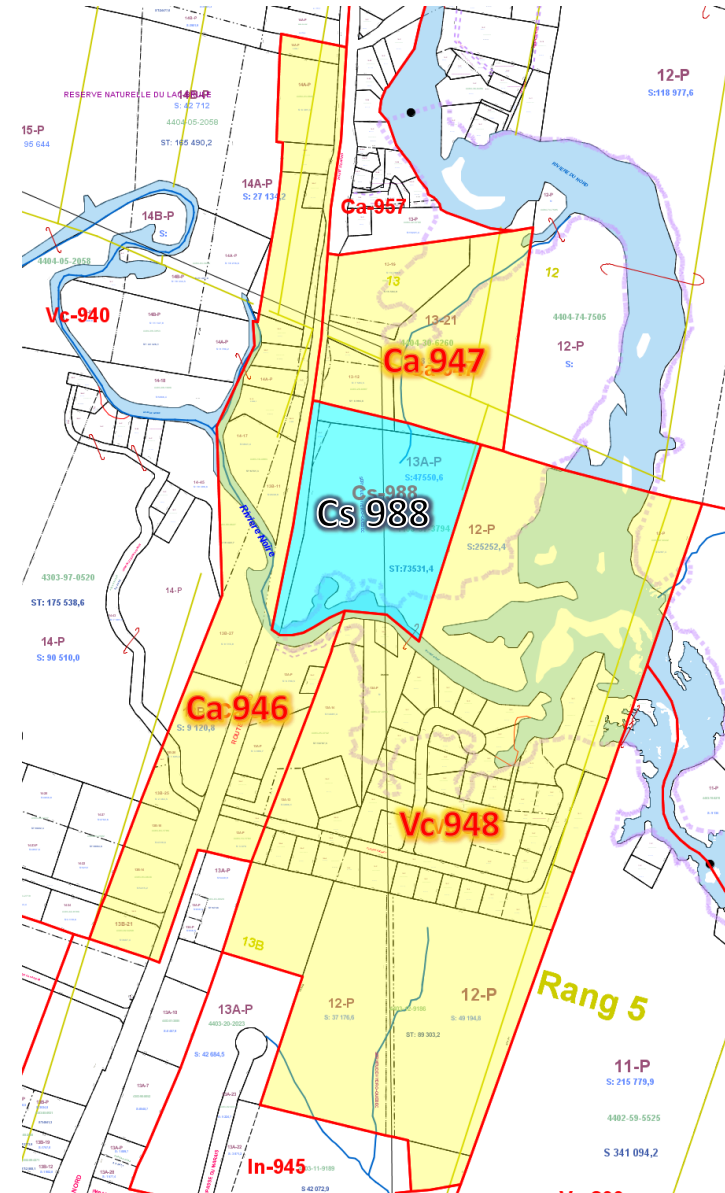
| Zone concernée | Zones contiguës |
|----------------|-----------------|
| Cs 988 | Ca 946 |
| | Ca 947 |
| | Vc 948 |



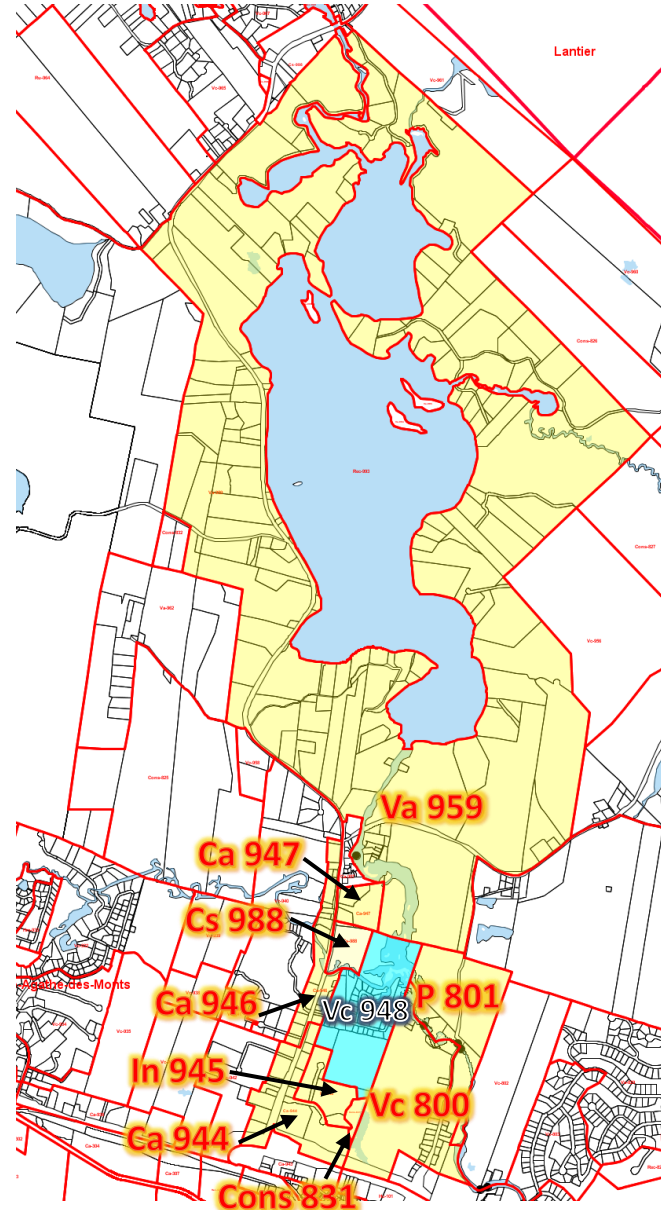

-  Zones contiguës
-  Zone Concernée

| Zone concernée | Zones contiguës |
|----------------|-----------------|
| Vc 948 | Vc 800 |
| | P 801 |
| | Cons 831 |
| | Ca 944 |
| | In 945 |
| | Ca 946 |
| | Ca 947 |
| | Va 959 |
| | Cs 988 |



1.2 2020-U53-82 modifiant le règlement de zonage 2009-U53 afin de modifier le plan de zonage ainsi que certaines grilles

-  Zones contiguës
-  Zone Concernée

| Zone concernée | Zones contiguës |
|----------------|-----------------|
| Cons 834 | Ca 946 |
| | Ca 947 |
| | Vc 948 |
| | Va 959 |
| | Cs 988 |

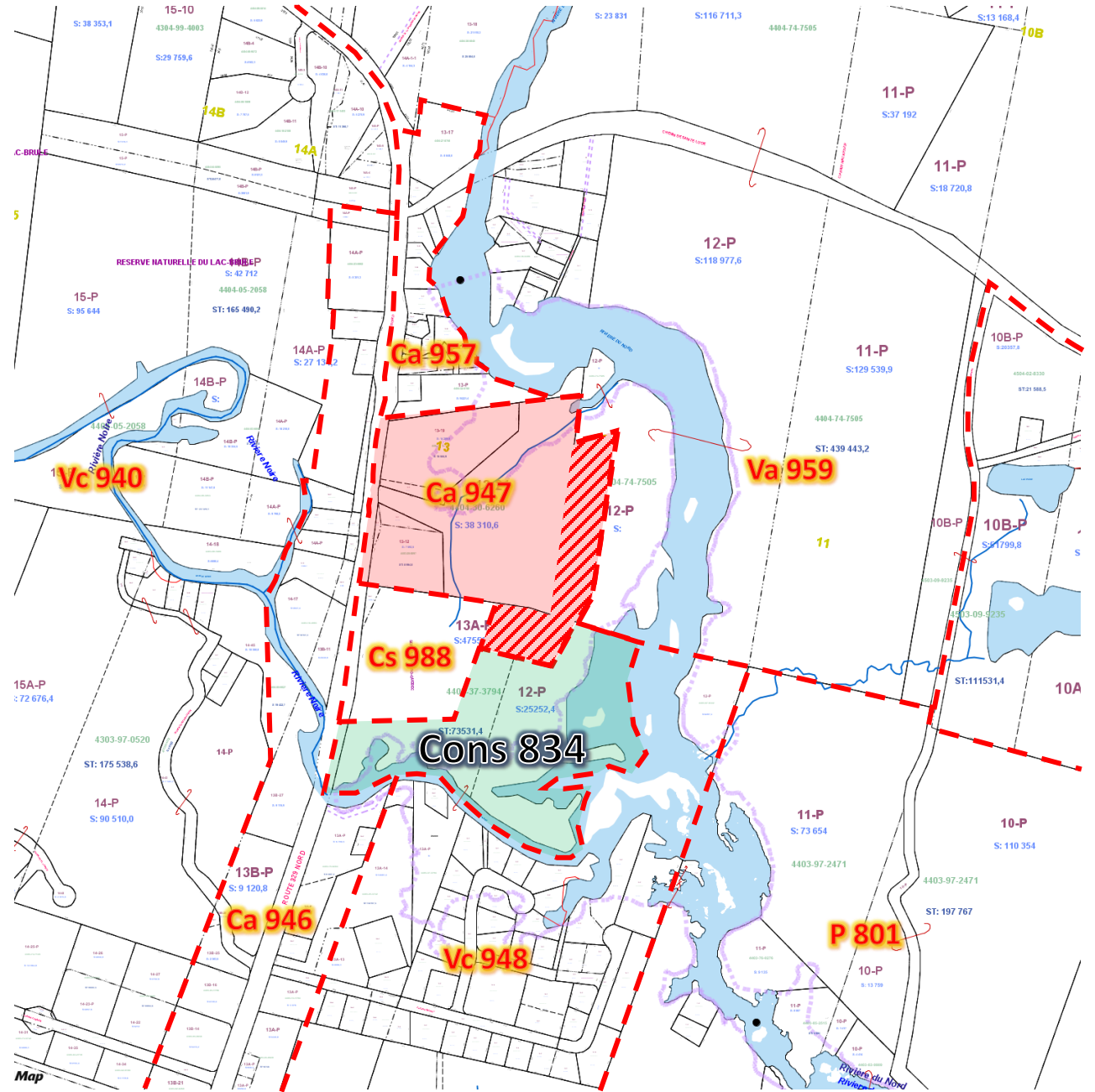

1.2 2020-U53-82 modifiant le règlement de zonage 2009-U53 afin de modifier le plan de zonage ainsi que certaines grilles

- Zones contiguës
- Zone Concernée

| Zone concernée | Zones contiguës |
|----------------|-----------------|
| Ct 200 | Hc 201 |
| | Hb 202 |
| | Ht 209 |
| | Ht 210 |
| | Ha 313 |
| | Ht 314 |
| | Hb 315 |
| | Ht 316 |

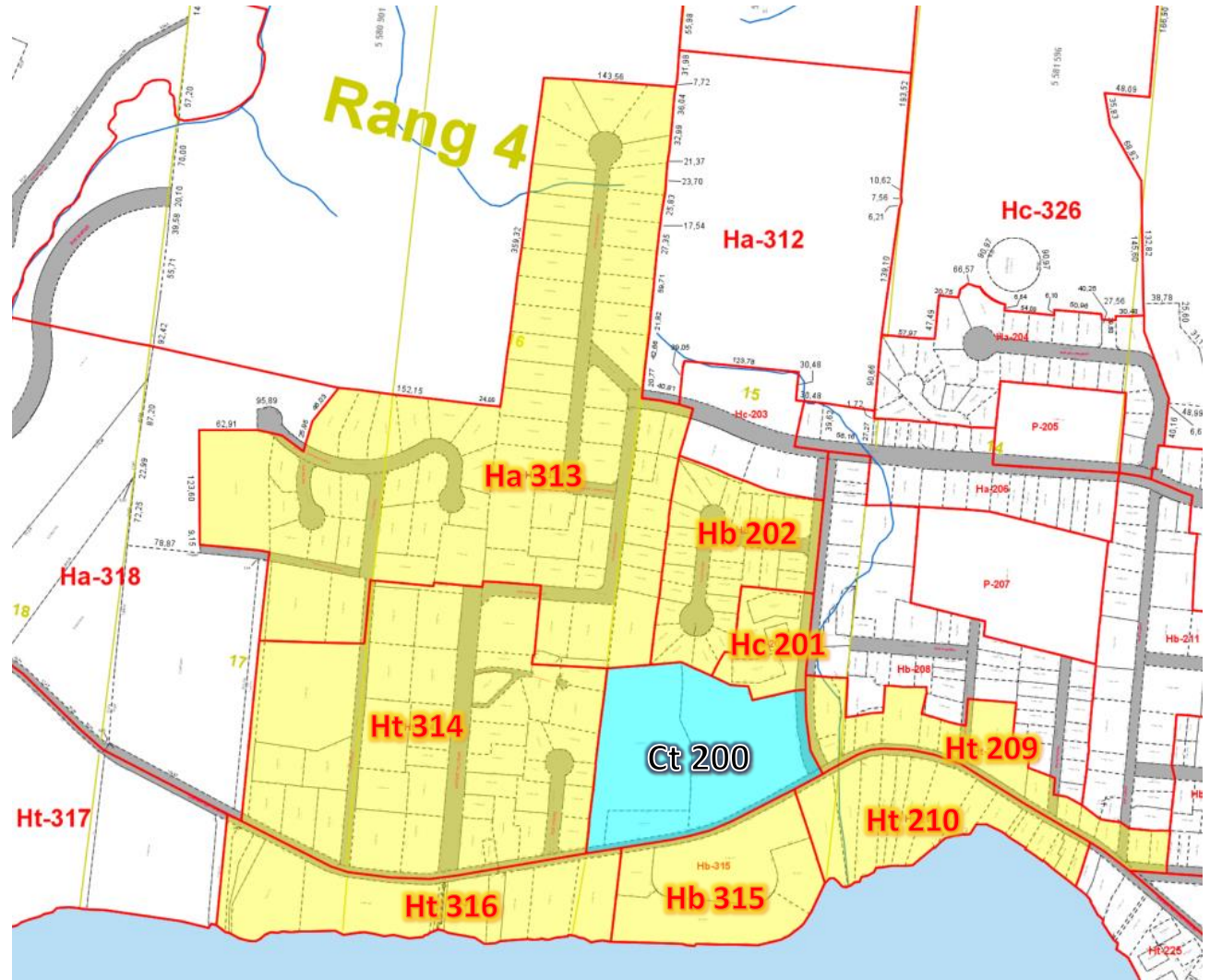

1.2 2020-U53-82 modifiant le règlement de zonage 2009-U53 afin de modifier le plan de zonage ainsi que certaines grilles

- Zones contiguës
- Zone Concernée

| Zone concernée | Zones contiguës |
|----------------|-----------------|
| Hc 101 | Ha 100 |
| | Ha 103 |
| | Up 104 |
| | Ha 105 |
| | Hc 125 |
| | Vc 800 |
| | Ha 804 |
| | In 816 |
| | Ca 943 |
| | Ca 944 |

